

# Adept Viper s650



## Specifications

Reach	653 mm
Payload	
Rated	2.5 kg
Max.	5 kg
Joint Ranges	
Joint 1	± 170°
Joint 2	-190°, +45°
Joint 3	-29°, +256°
Joint 4	± 190°
Joint 5	± 120°
Joint 6	± 360°
Inertia Moment (max.)	
Joint 4	0.295 kgm <sup>2</sup>
Joint 5	0.295 kgm <sup>2</sup>
Joint 6	0.045 kgm <sup>2</sup>
Joint Speeds	
Joint 1	328°/sec
Joint 2	300°/sec
Joint 3	375°/sec
Joint 4	375°/sec
Joint 5	375°/sec
Joint 6	600°/sec
Repeatability (XYZ)	± 0.02 mm
Pass-Through Connections (routed from robot base to link four)	
Electrical	10
Pneumatic	6 mm (x1)
Pneumatic	4 mm (x6)
Brakes	Joints 2 - 6
Mounting	floor, table, and ceiling
Weight	28 kg
Environmental Requirements	
Ambient Temperature	5 - 40 °C
Humidity Range	5 - 90 % (non-condensing)
Power Requirements SmartController	
	24 VDC : 5 A
Power Requirements for MotionBlox-60R	
	24 VDC : 6 A
	200-240 VAC : 10 A single phase
CE Compliant (cULus option)	

The Adept Viper™ s650 robot is part of a high-performance line of 6-axis robots designed for applications such as assembly, material handling, packaging, machine tending, and operations that require fast and precise automation. The Adept Viper s650 6-axis robot is available in standard, Cleanroom, and IP-54/65 versions.

## Product Features and Benefits

- Adept ACE™ software to deploy your applications through a user-friendly interface
- High-resolution, absolute encoders to provide high accuracy, superior slow-speed following, and easy calibration
- High-efficiency, low-inertia Harmonic Drives™ and a lightweight arm to deliver maximum acceleration
- 4 kHz servo update rate to improve path following and control
- Diagnostics display to enable quick troubleshooting
- Ethernet TCP/IP capability to control the robot through a PC, PLC, or controller
- Complete interchangeability between robots and controllers



The Adept Viper s650 6-axis robot comes with the high-performance Adept SmartController™ motion controller, which is based on the Adept SmartServo architecture. It has a small footprint of 329w x 187d x 86h mm.

# Adept Viper s650

## Dimensions: Adept Viper s650 (mm)

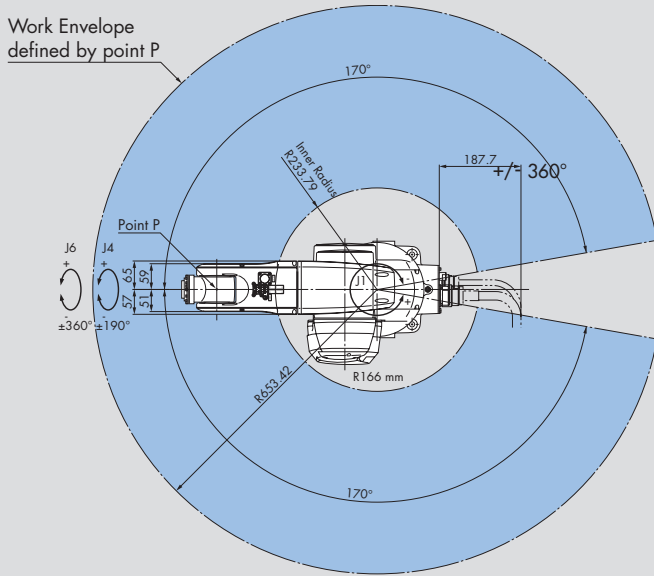

## Dimensions: Footprint (mm)

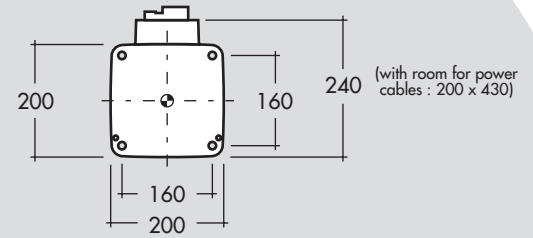

## Dimensions: Flange (mm)

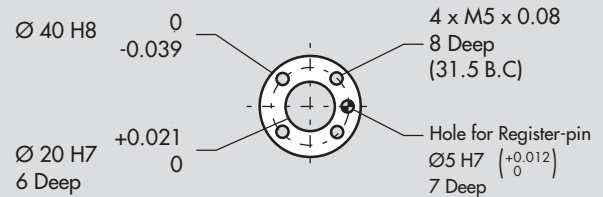

## The Adept Viper s650 system includes the following:

- Adept Viper s650 robot
- Adept SmartController motion controller
- MotionBlox-60R servo controller
- Front panel with E-Stop
- Adept ACE software
- User documentation

## Options and Peripherals:

- AdeptSight™ vision guidance and inspection system (requires a PC—Adept recommends using the Adept SmartVision™ EX)
- T2 manual control pendant
- Dual robot configuration option
- sMI6 SmartMotion™ interface
- sDIO I/O expansion (32 digital input and 32 digital output channels)
- Cleanroom ISO4 (class 10) option
- IP-54/65 version (IP-54 on the first three joints, IP-65 on the last 3 joints)
- UL listed option with Joint 1 brake
- Brake box

## Downloads:

- Download CAD files for the Adept Viper s650 robot from <http://www.adept.com/support/downloads/file-search> using the following download ID: 500500

## Dimensions: MotionBlox-60R (mm)

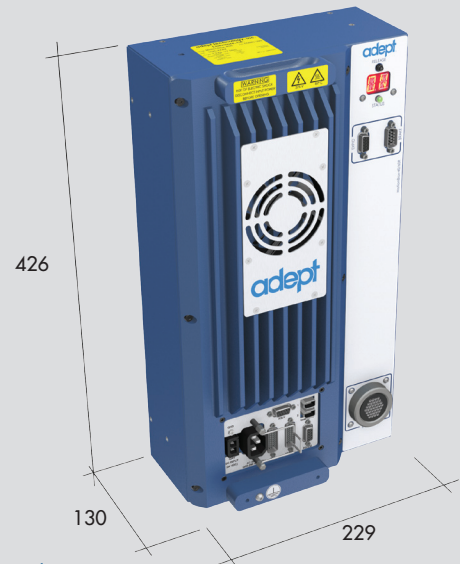

Adept Technology, Inc. 5960 Inglewood Drive, Pleasanton, CA 94588

Tel: 925-245-3400 Fax: 925-960-0452 Email: [info@adept.com](mailto:info@adept.com)

[www.adept.com](http://www.adept.com)

Specifications subject to change without notice.

©2011 Adept Technology, Inc. ALL RIGHTS RESERVED. The information provided in this communication or document is the property of Adept Technology, Inc. and is protected by copyright and other intellectual property laws. In addition, any references to any Adept Technology, Inc. products are the marks and property of Adept Technology, Inc. [and may be registered trademarks]. All other trademarks or tradenames are the property of their respective holders.